



Features

accuracy:
0.5 % FSO BFSL

nominal pressure ranges from
0 ... 1.6 bar up to 0 ... 250 bar

LE3

OEM Pressure Transmitter

Technical Data

Input pressure range

Nominal pressure gauge	[bar]	1.6	2.5	4	6	10	16	25	40	60	100	160 ¹	250 ¹
Permissible overpressure	[bar]	7	7	12	12	25	50	50	120	120	250	400	400

Output signal / Supply

Standard	2-wire:	4 ... 20 mA / V _s = 9 ... 30 V _{DC}
----------	---------	---

Performance

Accuracy ¹	BFSL: $\leq \pm 0.5\%$ FSO
Permissible load	$R_{max} = [(V_s - V_{smin}) / 0.02] \Omega$
Influence effects	supply: 0.05 % FSO / 10 V / load: 0.05 % FSO / k Ω

Thermal effects

Temperature error for offset and span in compensated range	$\leq \pm 0.5\%$ FSO / 10 K -25 ... 85 °C
--	--

Mechanical stability

Vibration	10 g RMS (20 ... 2000 Hz)	Shock	100 g / 11 ms
-----------	---------------------------	-------	---------------

Permissible temperatures

Medium	-25 ... 125 °C	Electronics / environment	-25 ... 85 °C	Storage	-40 ... 100 °C
--------	----------------	---------------------------	---------------	---------	----------------

¹ with nominal pressure P > 100 bar accuracy according to FSO (BFSL: $\leq \pm 1\%$ FSO)

Mechanical connection

Standard

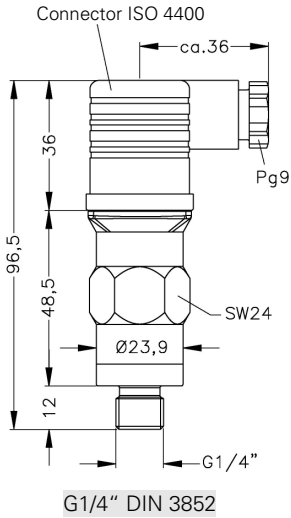

Option

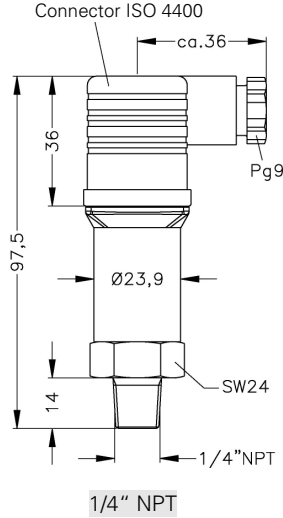

Electrical connection

Standard

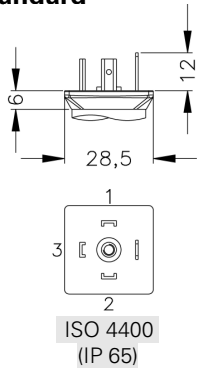

Options

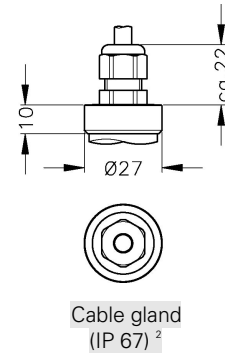
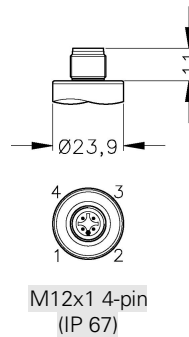

Materials	
Pressure port / Housing	stainless steel 1.4305 (303)
Seals (media wetted)	$P_N < 100$ bar: FKM / $P_N \geq 100$ bar: NBR
Diaphragm	ceramics Al_2O_3 96 %
Media wetted parts	pressure port, seals, diaphragm

Pin configuration				
Electrical connection		ISO 4400	M12x1 (4-pin)	cable colours (DIN 47100)
2-wire-system	Supply +	1	1	white
	Supply -	2	2	brown
	Ground	ground contact	4	yellow / green (shield)

Wiring diagram

2-wire-system (current)

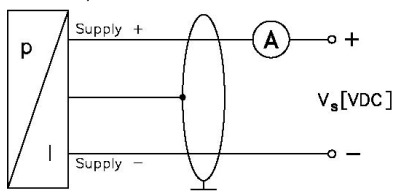

² standard: 2m PVC cable (without ventilation tube)

LE3

OEM Pressure Transmitter

Ordering code LE3

LE3		-	-	-	-	-	-	-	-	-
Input	[bar]									
	1.6	1	6	1						
	2.5	2	5	1						
	4.0	4	0	1						
	6.0	6	0	1						
	10	1	0	2						
	16	1	6	2						
	25	2	5	2						
	40	4	0	2						
	60	6	0	2						
	100	1	0	3						
	160	1	6	3						
	250	2	5	3						
	-1...0.6	X	1	6						
	customer	9	9	9						
Pressure										
	gauge			R						
Output										
	4 ... 20 mA / 2-wire			1						
Accuracy										
	0.5 %			8						
	customer			9						
Electrical connection										
	Male and female plug ISO 4400			1	0					
	Cable gland incl. cable ¹			4	0					
	M12x1 (4-pin)			M	1					
	customer			9	9					
Mechanical connection										
	G1/4" DIN 3852			3	0					
	1/4" NPT			N	4					
	customer			9	9					
Design										
	hexagon on housing				1					
	hexagon on pressure port ²				2					
Seals										
	for P _N < 100 bar								1	
	for P _N ≥ 100 bar								5	
	customer								9	
Special version										
	standard									S
	customer									C

¹ different cable types and lengths deliverable, standard: 2 m PVC cable without ventilation tube, optionally cable with ventilation tube

² 1/4" NPT only with type of construction "hexagon onto pressure port" available